

SPARE PARTS LIST
LTW PIPE GRAB TYPE GZ 2,5 t



manufacturer: **LTW Tiefbauvertriebs GmbH**
Holter Weg 11
D – 41836 Hückelhoven-Brachelen

phone: +49 (0) 24 62 / 2009 0
fax: +49 (0) 24 62 / 2009 15
e-mail: info@ltw-verbau.de
homepage: <http://www.ltw-shoring.com>

SPARE PARTS LIST

LTW PIPE GRAB TYPE GZ 2,5 t



arm type I – 50

arm type II – 80

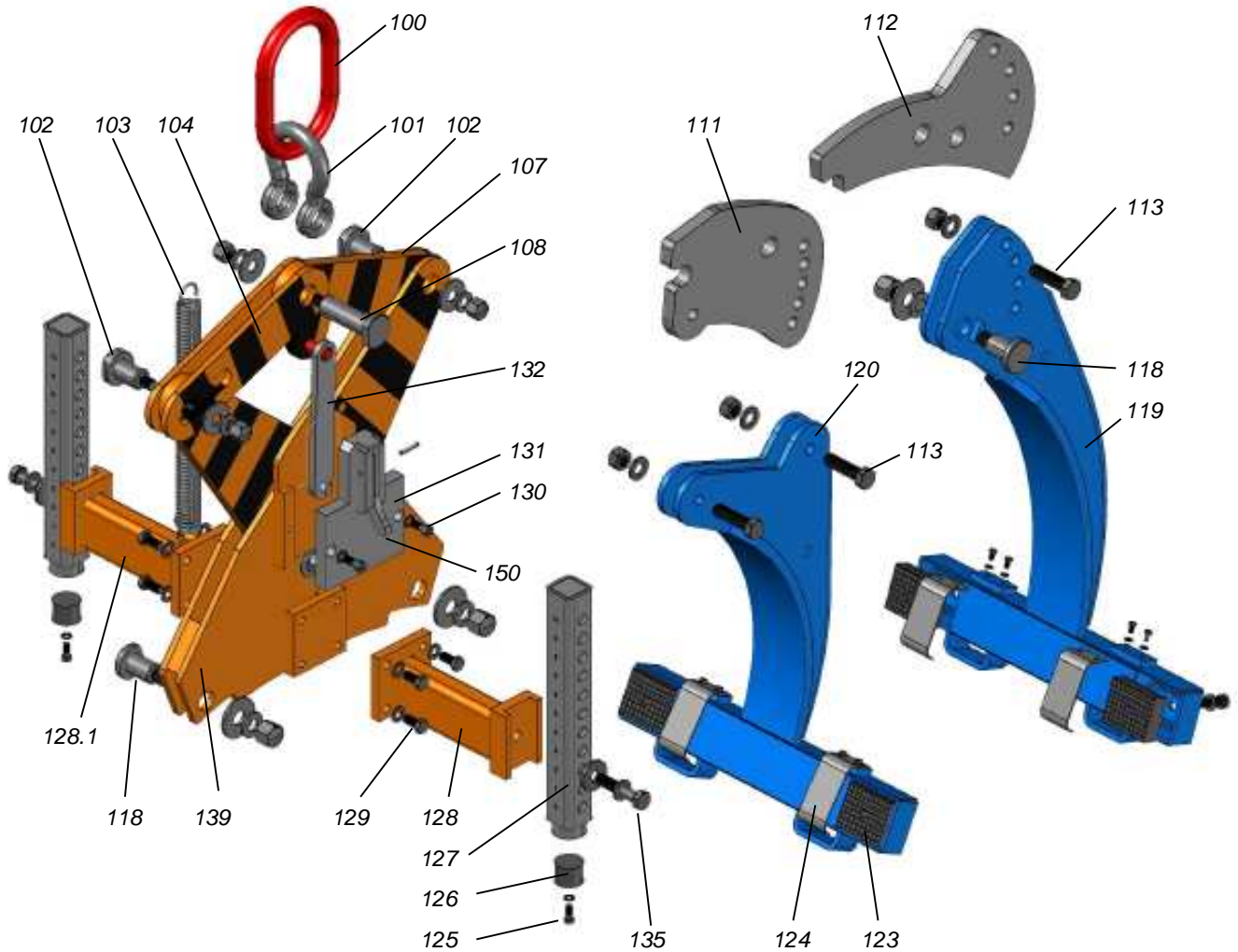

pos.	description	code	qty.	pos.	description	code	qty.	pos.	description	code	qty.
		50 201				50 201	Arm 50 / 80			50 201	
100	master link	0049	1	108	shackle bolt M16 30*93	0020	1	127	support cpl.	0019	2
101	shackle	0031	1	111	adjustment plate arm 50	0012	2 / 0	128	support holder cpl.	0010	1
102	bolt M16 30*43	0030	3	112	adjustment plate arm 80	0026	0 / 2	128.1	support holder cpl. with spring holder	0008	1
103	spiral spring	0002	1	118	bolt M20 30*42	0032	2 / 4	131	switch plate	0007	1
104	flap with slot	0028	2	119	arm type II - 80	50 200 0004	0 / 2	132	switch rod	0004	1
107	flap with spring holder	0029	1	120	arm type I - 50	50 200 0003	2 / 0	139	base plate 1 cpl.	0040	1

SPARE PARTS LIST

LTW PIPE GRAB TYPE GZ 2,5 t



spare parts - subassembly

pos.	description	code	qty.
		50 201	
127	support cpl. with:	0019	1
125	hexagon screw M8*20		1
126	rubber buffer	50 033 0005	1
128	support holder with:	0010	1
129	hexagon screw M12*25	0009	4
	spring washer A12		4
128.1	support holder with spring	0008	1
129	hexagon screw M12*25	0009	4
	spring washer A12		4
119	arm type II – 80 cpl. with:	50 200 0004	1
112	adjustment plate arm 80	0026	1
113	hexagon screw M18*65 cpl.	0052	1
118	bolt M20 30*42 cpl.	0032	1
123	steel jaw cpl.	0005	2
124	leaf spring cpl.	0001	2
120	arm type I – 50 cpl. with:	50 200 0003	1
111	adjustment plate arm 50	0012	1
113	hexagon screw M18*65 cpl.	0052	2
123	steel jaw cpl.	0005	2
124	Leaf spring cpl.	0001	2
123	steel jaw cpl. with:	0005	1
	hexagon screw M12*50	0050	1
	spring washer A12		1
124	leaf spring cpl. with:	0001	1
	hexagon screw M6*10	0039	2
	spring washer A6		2
131	switch plate cpl. with:	0007	1
	switch plate		1
	distance spring	0047	1
130	cylinder head screw M10*20	0024	2
150	safety latch cpl.	0003	1
150	safety latch cpl. with:	0003	1
	safety latch		1
	spring for safety latch	0015	1
	spring dowel pin 6*32		1

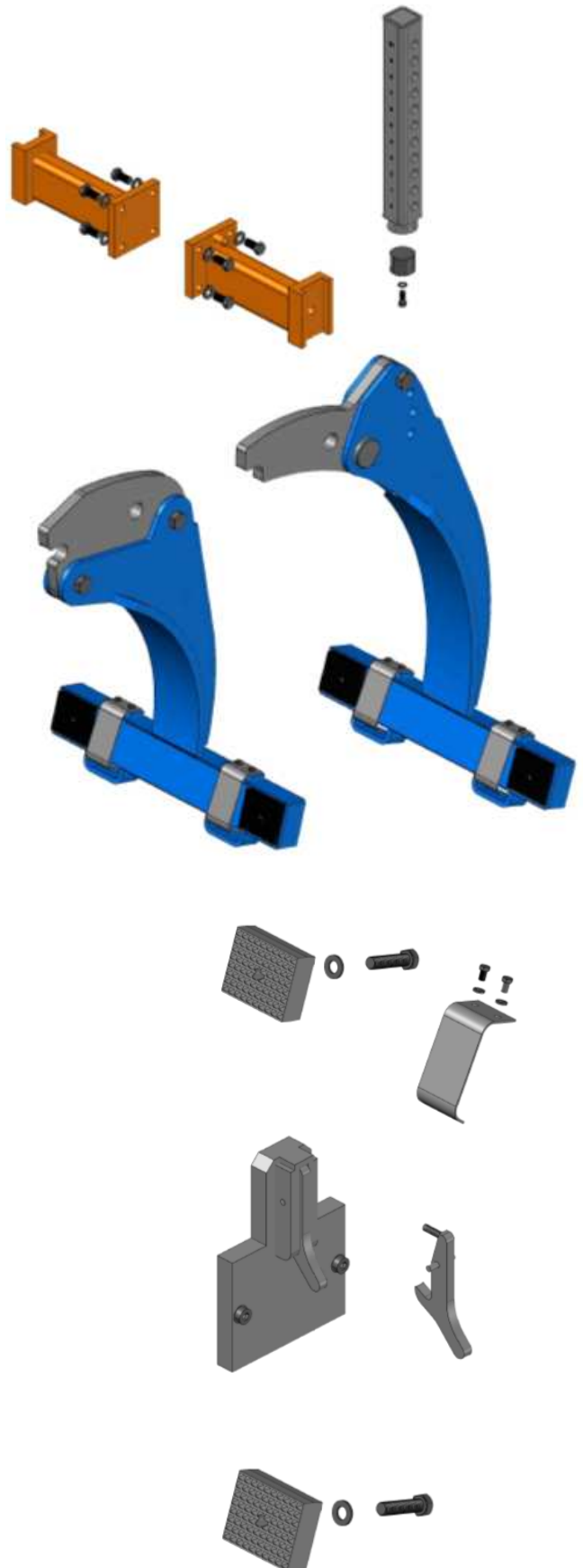

special accessoires for stoneware pipes

pos.	description	code	qty.
		50 201	
123 G	rubber jaw cpl. with:	0011	4
	hexagon screw M12*40	0051	4
	spring washer A12		4

SPARE PARTS LIST

LTW PIPE GRAB TYPE GZ 2,5 t



spare parts – bolts / screws

pos.	description	for connection between	code
			50 201
102	bolt M16 30*43 with: washer 58*5*18 spring washer A16 nut M16	grab head flaps – base plate base plate – base plate	0030 0042 0034
108	shackle bolt M16 30*93 with: washer 58*5*18 spring washer A16 nut M16	grab head shackle – flaps	0020 0042 0034
118	bolt M20 30*42 with: washer 68*5*22 spring washer A20 nut M20	grab head / -arm base plate – arm arm 80 – adjustment plate	0032 0036 0035
113	hexagon screw M18*65 with: washer 58*5*18 spring washer A18 hexagon nut M18	grab arms arms – adjustment plate	0052 0042 0053
130	cylinder head screw M10*25 with: toothed washer A10	grab head base plate – switch plate	0024
135	hexagon screw M16*90 with: washer 58*5*18 spring washer A16	grab head support – support holder	0043 0042

